

Electric manipulator robots BE66

Description

- Transport and assembly of different parts
- High speed and precision
- Repeatability of sequences
- Numerous application possibilities
- Independently adjustable picking up and setting down positions
- Independently adjustable movement speeds
- Two possible communication modes
- Optional vertical rotary gripper
- Optional horizontal rotary gripper



To order these electric manipulator robots

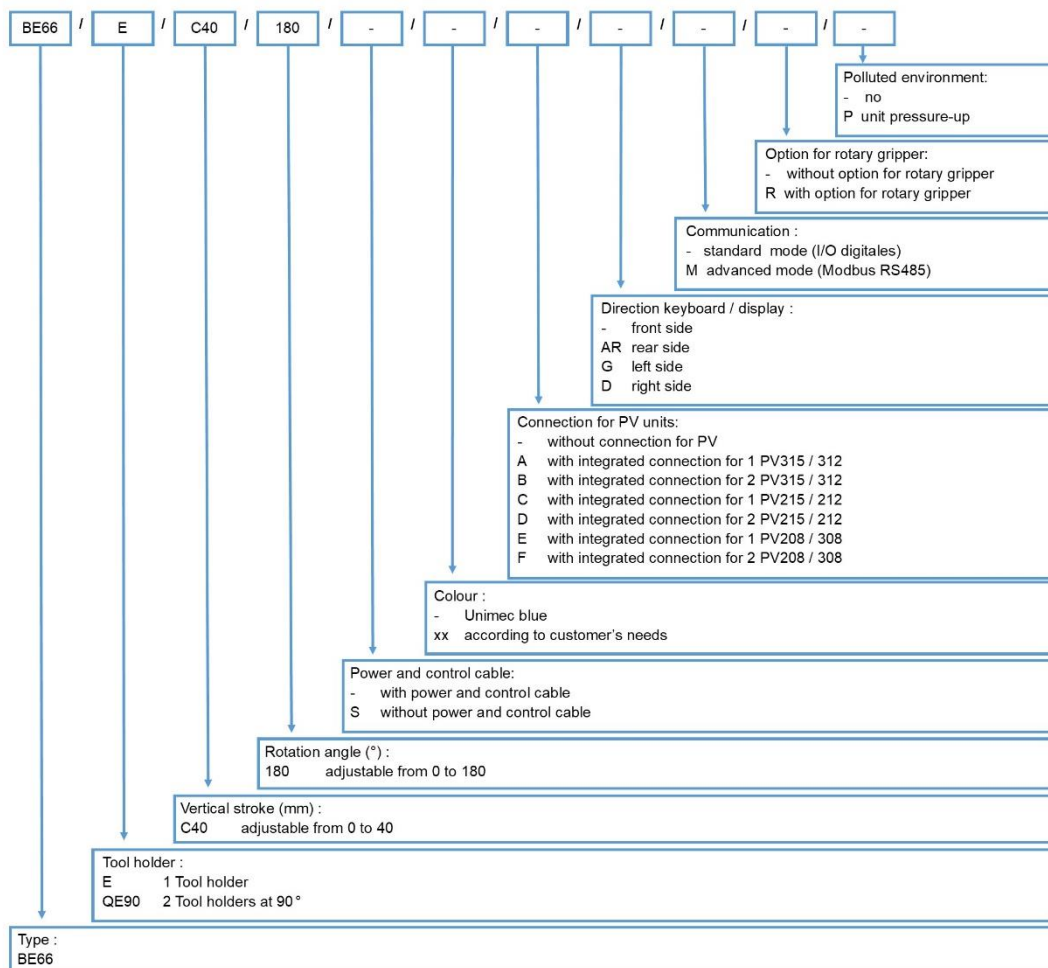

Technical data

Repeatability	+/- 5 µm
Working rate	Up to 100 cycles/min
Weight	2,2 kg
Payload	200 gr

Combinable with

Positioning slides CX66 / CL66
 Tool holders
 Pressure and vacuum units PV
 Horizontal rotary gripper
 Vertical rotary gripper



Dimensions and plans - BE66

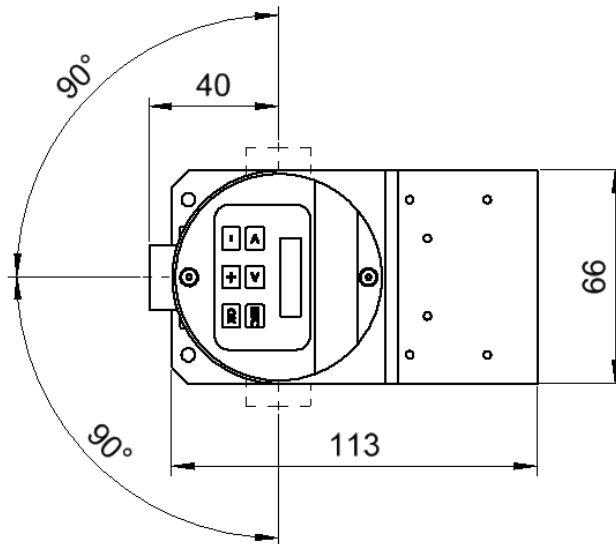
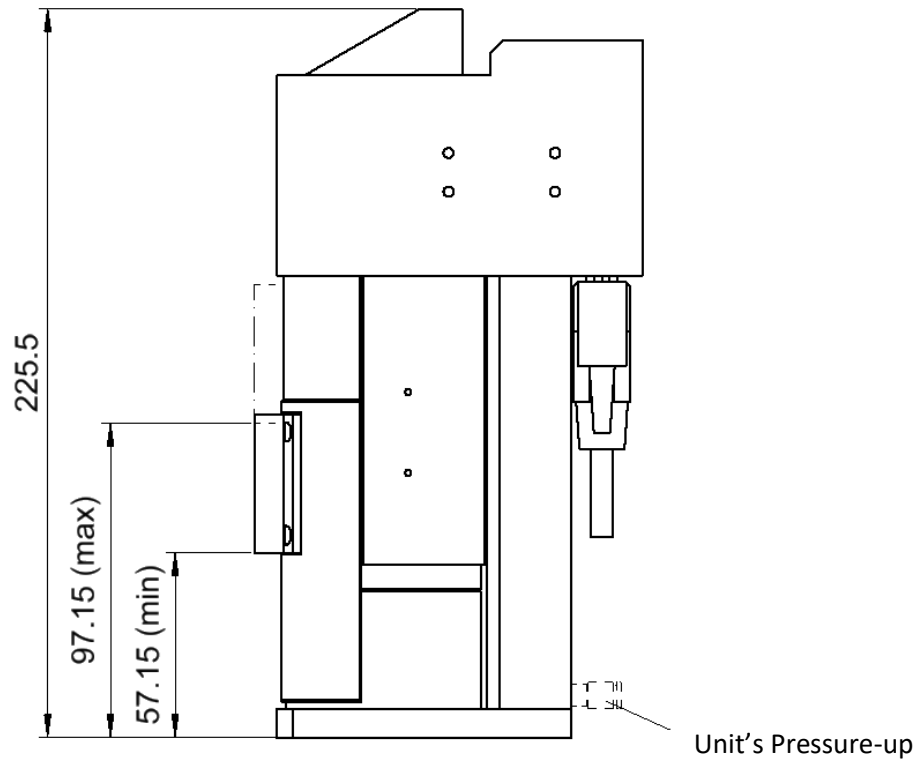

Accessories

Tool holders

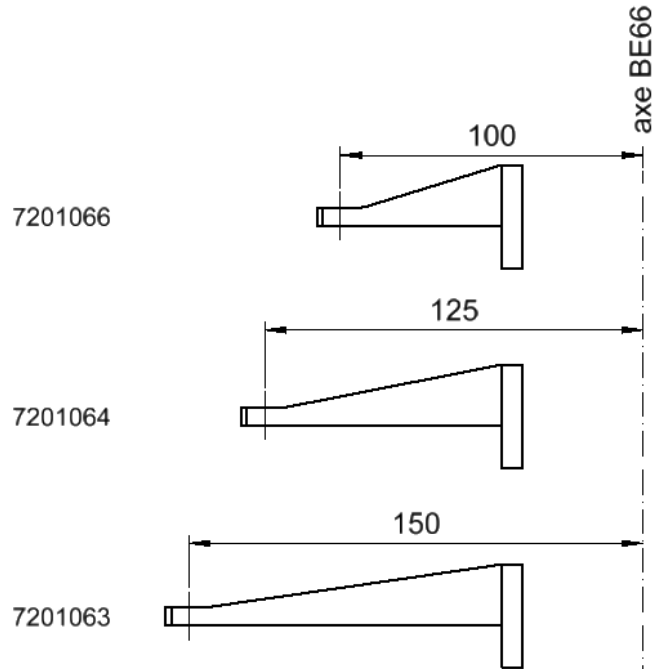

Horizontal rotary gripper

